



future automation

# WB80

2020 DESIGN REVISION

UK +44 (0) 1438 833577  
US +1 (603) 742 9181

[WWW.FUTUREAUTOMATION.NET](http://WWW.FUTUREAUTOMATION.NET)

# WB80

## WALL BOX FOR PS80 ARTICULATING WALL MOUNT



This redesign was engineered following feedback from our Dealers to improve the logistics of transporting and integrating this product.

Feedback from our dealers surrounding the previous WB80 was that they were difficult to fit into their vehicles because of their volumetric footprint. There was also a high risk of damaging other areas of the project carrying the large box through to the installation location, as it didn't easily fit through a doorway.

We've therefore greatly reduced the volume of the WB80 packaging, so it is easier for your installation teams to transport and carry onto site. Once assembled, the new WB80 dimensions are identical to the previous version.

We also took this opportunity to add additional accessory mounting points, which allow you to fit a wider variety of AV equipment behind the display.

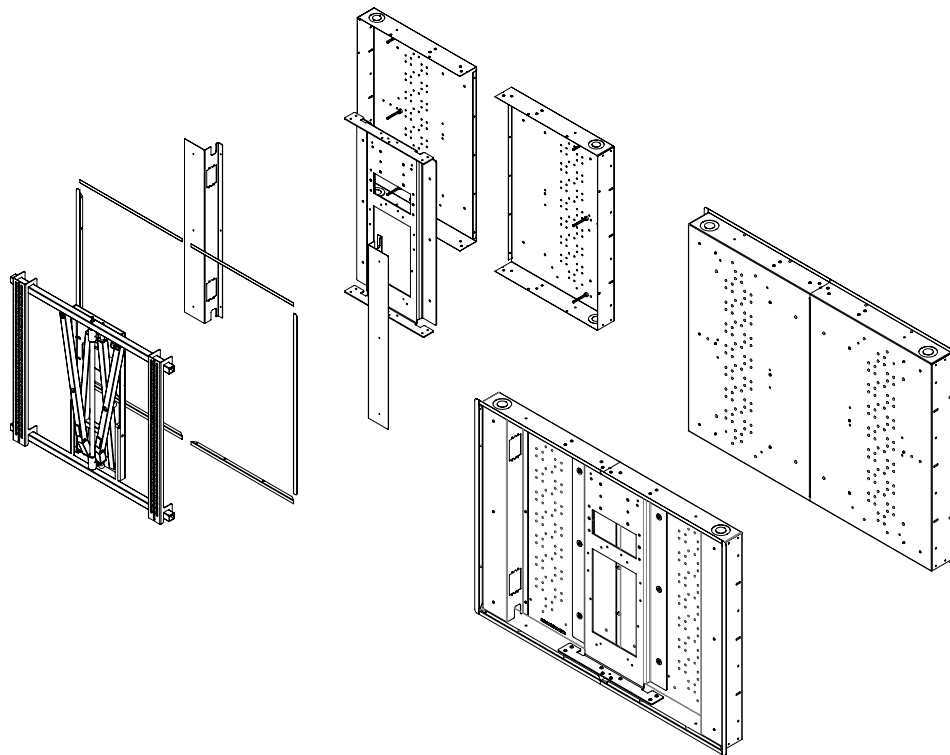

### WHAT'S NEW?

- Easier to carry through to site with less risk of damage
- Quick and easy one-man assembly
- Additional mounting points for AV accessories
- 3x pairs of accessory mounting clamps included
- Reduced packaging volume making it easier to transport
- Less space needed to store prior to installation

### WHAT'S THE SAME?

- Product dimensions
- After assembly, the installation process is identical
- Weight capacity - 120kg (265lbs)
- Cable management locations
- Trim panel covers
- Identical structural rigidity from redesigned central plate